



## INSTALLATION INSTRUCTIONS

## Single Spring Arm Kits

Related Instructions,  
How-To Videos & More



[Web: Parts](#)



[PDF: Arm Catcher for Automatic Systems](#)



[PDF: Smart Switch Basic Kit](#)



[PDF: High Amp Switch Kit](#)



[Web: Locate a Service Center](#)

501-0713, 501-0714, 501-0731, 501-0759, 501-0760,  
501-0761, 501-0762, 501-0763, 501-0764, 501-0765,  
501-0784, 501-0785, 501-0786

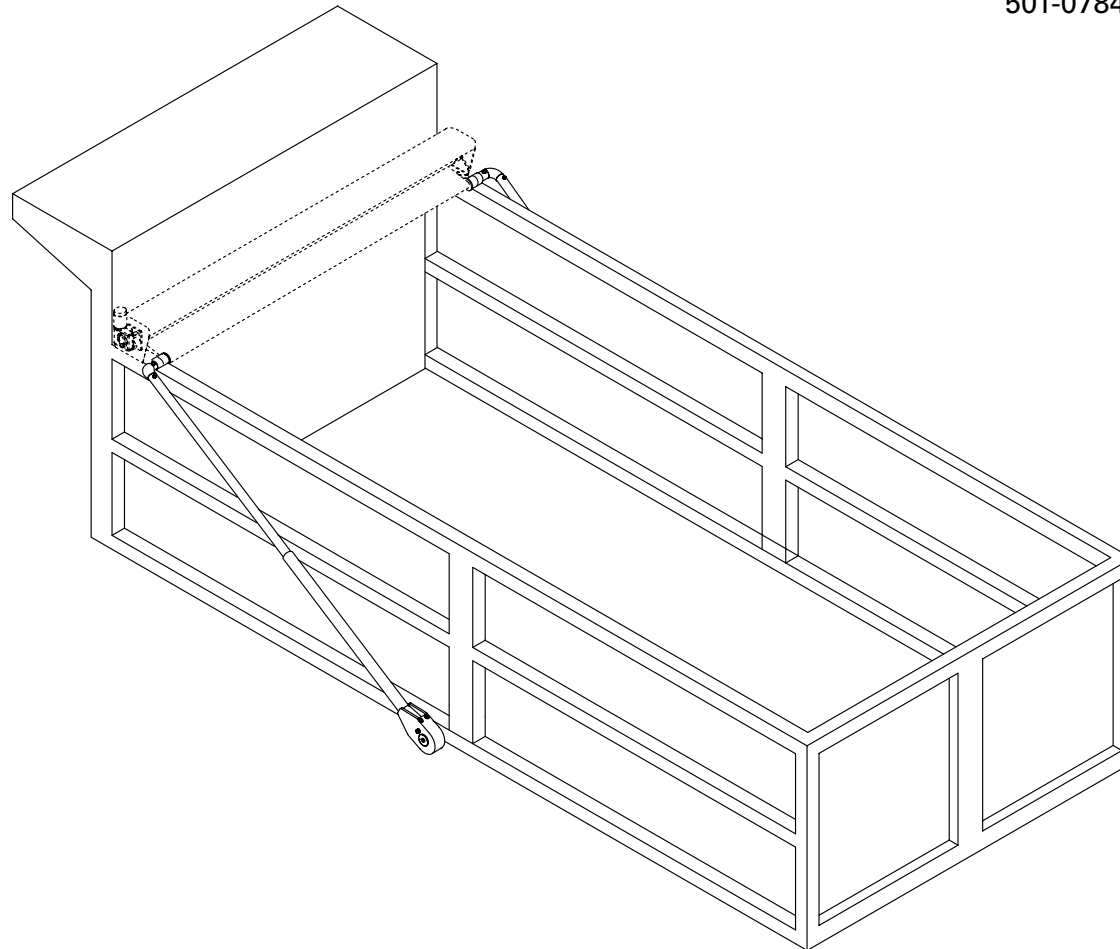

Document #: 607-0110  
Revised: 03/13/25 WLH

**DURING INSTALLATION, SOME FABRICATION MAY BE REQUIRED.**



**Table of Contents**

**Tools, Diagrams & Parts**

Recommended Tools ..... 2

Single Spring Pivots with Steel Arms #501-0713, 501-1763 ..... 3

Single Spring Pivots w/Aluminum Arms #501-0714, 501-0731, 501-1764, 501-1765  
(No Wire) #501-0764, 501-0765, 501-0785, 501-0786 (With Wire 90' & 100') ..... 4

Single Spring Housing Assembly #501-1101 (Driver-Shown), #501-1102 (Pass.-  
Opposite) ..... 5

**Installation**

Determining the Pivot Points and Mounting Locations ..... 7

Arm Alignment, Tarp and Pullbar Installation ..... 8

Quick Disconnect Plug Assembly ..... 9

Optional Flap Tarp, Rope and Hook Installation ..... 10

Bungee Cord Installation ..... 11

Flap, Rope and Rope Hook Placement ..... 12



**PULLTARPS**



**INSTALLATION INSTRUCTIONS**

**Single Spring Arm Kits**

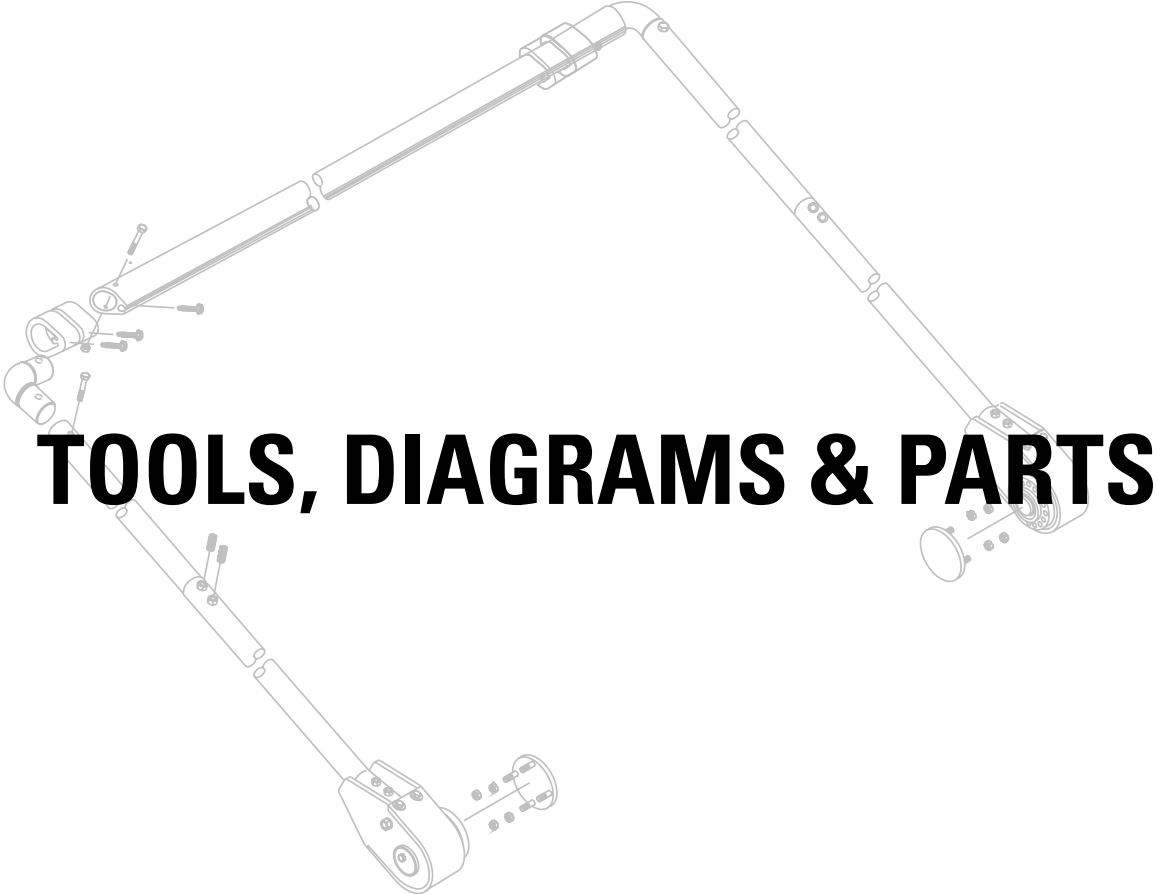



**INSTALLATION INSTRUCTIONS**

**Single Spring Arm Kits**

**Recommended Tools**



Safety Glasses and Gloves



Welding Equipment & Helmet

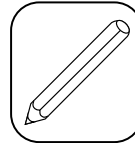

Pencil or Marker

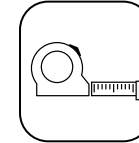

Tape Measure



Adjustable Wrench

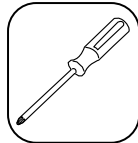

Philips Screwdriver

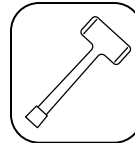

Mallet or Deadblow Hammer

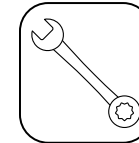

3/4" Box Wrench



Socket Wrench

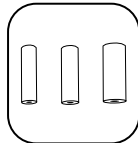

3/4", 7/16" & 5/16" Sockets

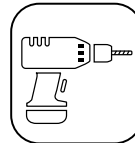

Impact Drill (Optional)



**INSTALLATION INSTRUCTIONS**

**Single Spring Arm Kits**

**Single Spring Pivots with Steel Arms #501-0713, 501-1763**

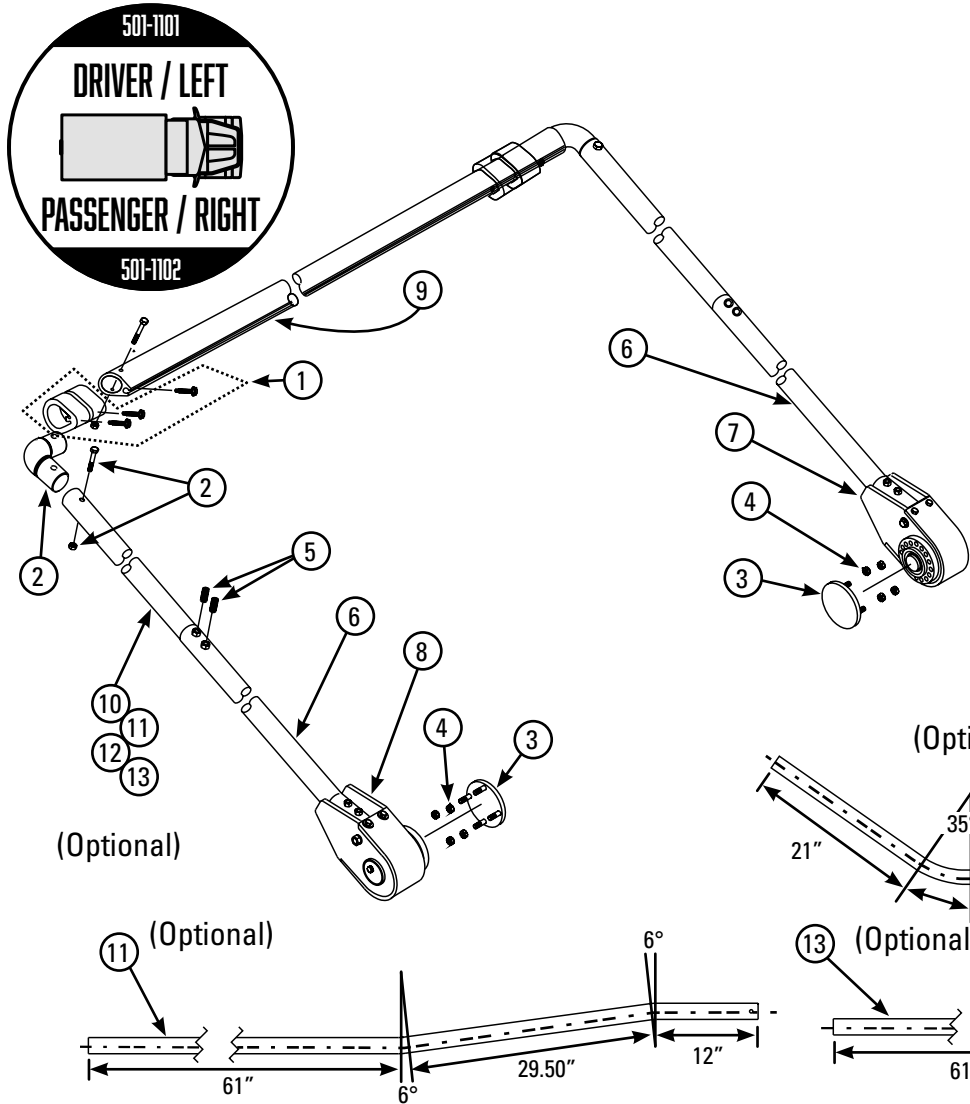

| ITEM | PART #   | DESCRIPTION                       | QTY |
|------|----------|-----------------------------------|-----|
| 1    | 501-1293 | Teardrop Bumper Kit               | 1   |
| 2    | 501-1251 | Elbow Kit (For Steel)             | 1   |
| 3    | 501-2237 | 4" Arm Adaptor Plate Assembly     | 2   |
| 4    | 504-3705 | 3/8" - 16 Nyloc Nut (Thin)        | 8   |
| 5    | 506-5008 | 1/2" - 13 x 3/4" Ig. Set Screw    | 4   |
| 6    | 501-1201 | Lower Arm with Nuts               | 2   |
| 7    | 501-1101 | Single Spring Housing (Driver)    | 1   |
| 8    | 501-1102 | Single Spring Housing (Passenger) | 1   |
| 9    | 501-0430 | Universal Teardrop Pullbar        | 1   |
| --   | 514-0213 | 6Ga. Electric Wire                | 90' |

**Arm Options**

| ITEM | PART #   | DESCRIPTION                        | QTY |
|------|----------|------------------------------------|-----|
| 10   | 501-1202 | Steel Upper Arm Tubing             | 2   |
| 11   | 501-1204 | Offset Upper Arm Tube              | 2   |
| 12   | 501-1205 | Upper Arm Tubing, Drilled and Bent | 2   |
| 13   | 501-1207 | Offset Upper Arm Tube              | 2   |

REV. 12/20/21 WLH



**INSTALLATION INSTRUCTIONS**

**Single Spring Arm Kits**

**Single Spring Pivots w/Aluminum Arms #501-0714, 501-0731, 501-1764, 501-1765 (No Wire)  
#501-0764, 501-0765, 501-0785, 501-0786 (With Wire 90' & 100')**

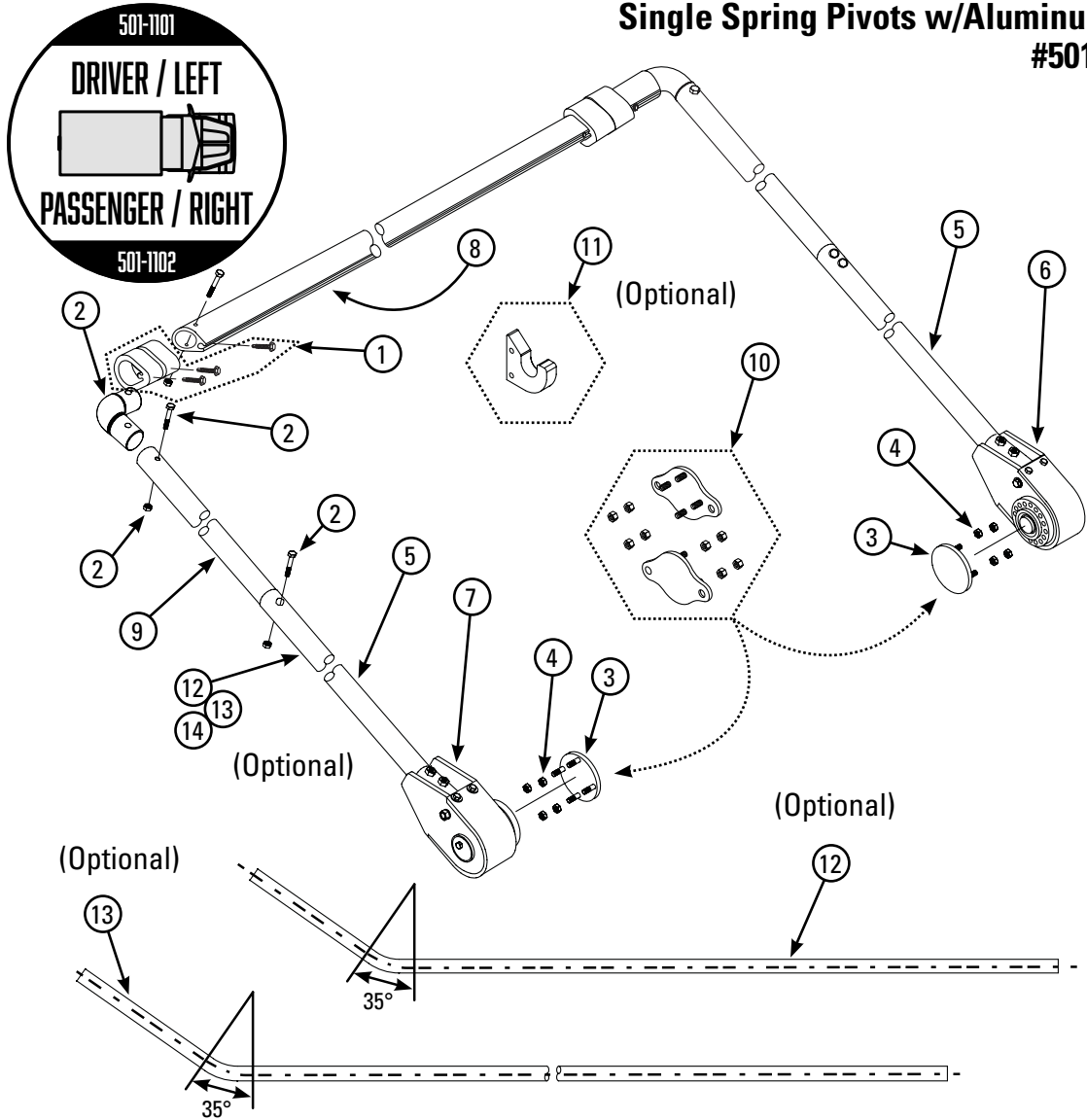

| ITEM | PART #   | DESCRIPTION                         | QTY |
|------|----------|-------------------------------------|-----|
| 1    | 501-1293 | Teardrop Bumper Kit                 | 1   |
| 2    | 501-0791 | Elbow Kit (For Alum. with Teardrop) | 1   |
| 3    | 501-2237 | 4" Arm Adaptor Plate Assembly       | 2   |
| 4    | 504-3705 | 3/8" - 16 Nyloc Nut (Thin)          | 8   |
| 5    | 501-1209 | Aluminum Lower Arm Tube             | 2   |
| 6    | 501-1101 | Single Spring Housing (Driver)      | 1   |
| 7    | 501-1102 | Single Spring Housing (Passenger)   | 1   |
| 8    | 501-0430 | Universal Teardrop Pullbar          | 1   |

**Options**

| ITEM | PART #   | DESCRIPTION                        | QTY |
|------|----------|------------------------------------|-----|
| 9    | 501-1211 | Aluminum Upper Arm or Pullrod      | 2   |
| 10   | 501-2235 | EZ-Mount Assembly                  | 2   |
| 11   | 501-1247 | Arm Catcher Assembly (Optional)    | 1   |
| 12   | 501-1214 | Upper Arm Tubing, Drilled and Bent | 2   |
| 13   | 501-1216 | Aluminum Upper Arm Tube Bent - 12' | 2   |
| 14   | 501-1212 | Aluminum Upper Arm Tube - 12'      | 2   |

REV. 03/03/23 WLH



**INSTALLATION INSTRUCTIONS**

**Single Spring Arm Kits**

**Single Spring Housing Assembly  
#501-1101 (Driver-Shown), #501-1102 (Pass.-Opposite)**

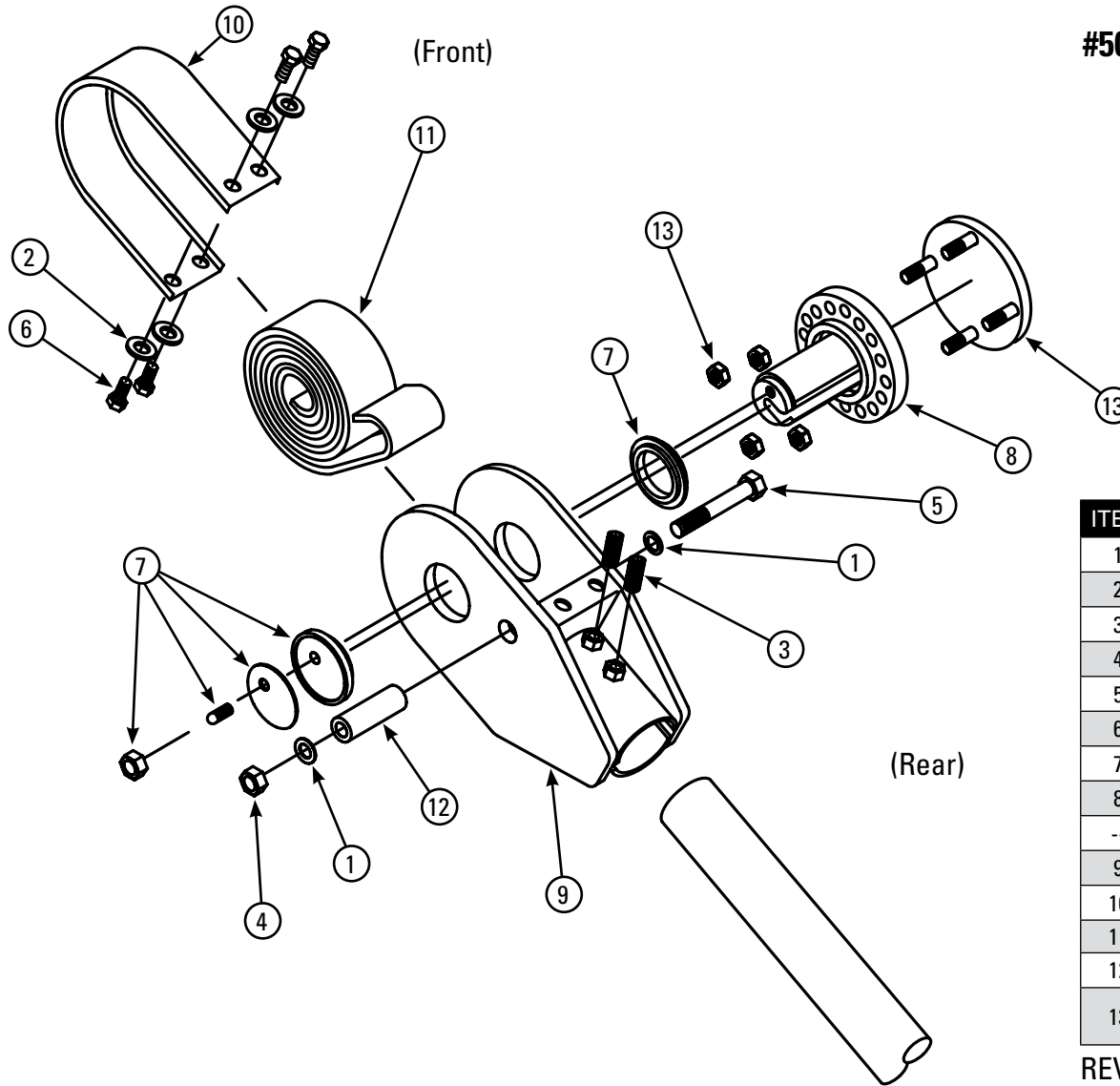

| ITEM | PART #   | DESCRIPTION  | QTY |
|------|----------|--|-----|
| 1    | 505-5001 | 1/2" AN Flat Washer  | 2   |
| 2    | 505-2502 | 1/4" Flat Washer USS   | 4   |
| 3    | 506-5008 | 1/2" - 13 x 3/4" Set Screw   | 2   |
| 4    | 504-5004 | 1/2" - 13 Nyloc Nut  | 1   |
| 5    | 503-5011 | 1/2" - 13 x 3-1/4"lg. HHCS Bolt  | 1   |
| 6    | 503-2503 | 1/4" - 20 x 1/2"lg. HHCS Bolt  | 4   |
| 7    | 501-1181 | Bushing Kit  | 1   |
| 8    | 501-1119 | Pivot Assembly (Driver)  | 1   |
| --   | 501-1120 | Pivot Assembly (Passenger-Not Shown)   | 1   |
| 9    | 501-1109 | Spring Side Plate Assembly   | 1   |
| 10   | 501-1151 | Arm Dust Cover   | 1   |
| 11   | 501-1156 | Rolled Spring Assembly with Strip  | 1   |
| 12   | 501-1158 | Spring Connection (Arm System)   | 1   |
| 13   | 501-2237 | 4" Arm Adaptor Plate Assembly<br>(Not part of Kit - Must be ordered separately.) | 1   |

REV. 10/13/16 WLH



**PULLTARPS**



**INSTALLATION INSTRUCTIONS**

**Single Spring Arm Kits**

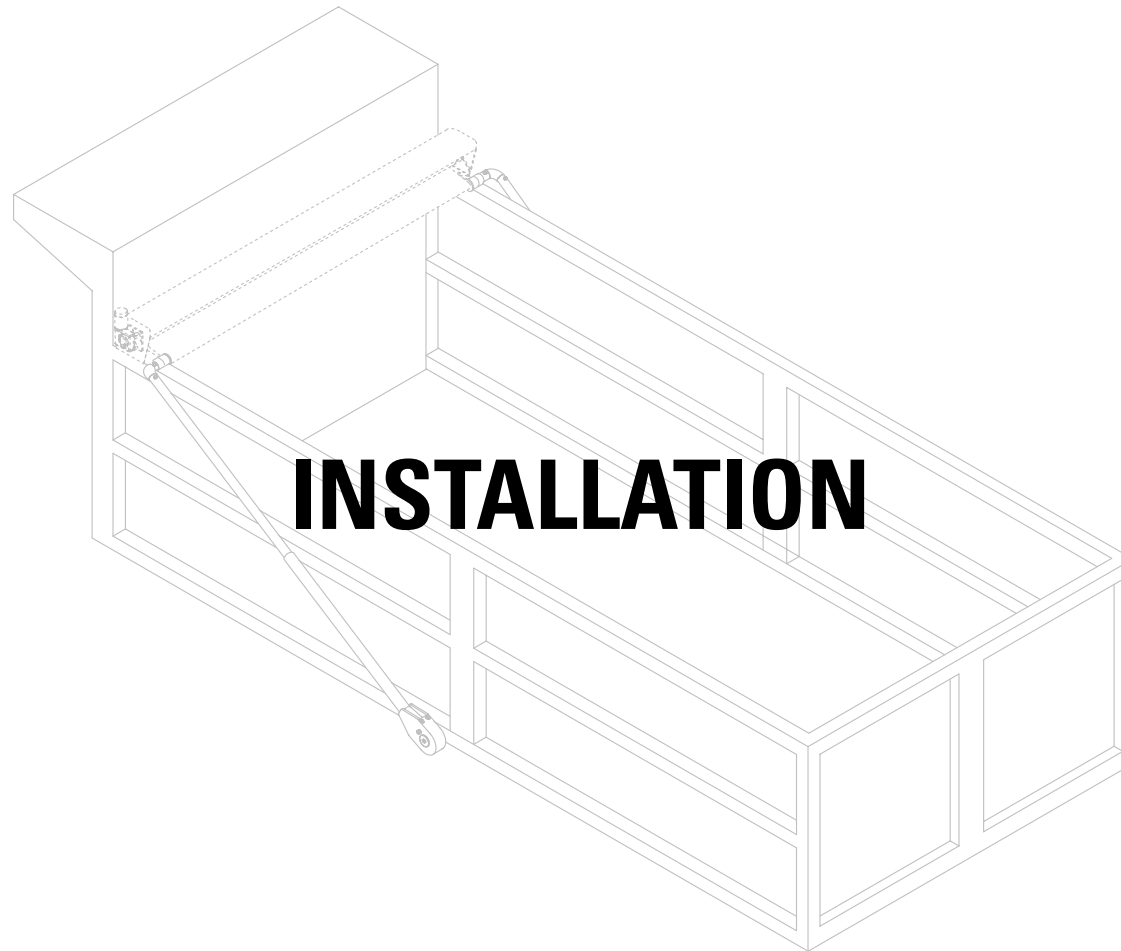





**INSTALLATION INSTRUCTIONS**

**Single Spring Arm Kits**

**Determining the Pivot Points and Mounting Locations**

**Step 1 - Mounting Positions:** Locate the proper mounting positions by determining Point "A" and Point "B" and insuring measurement "D" and "E" are equal (Fig. 1). Point "C" must be located as low as possible. Mark pivot location.

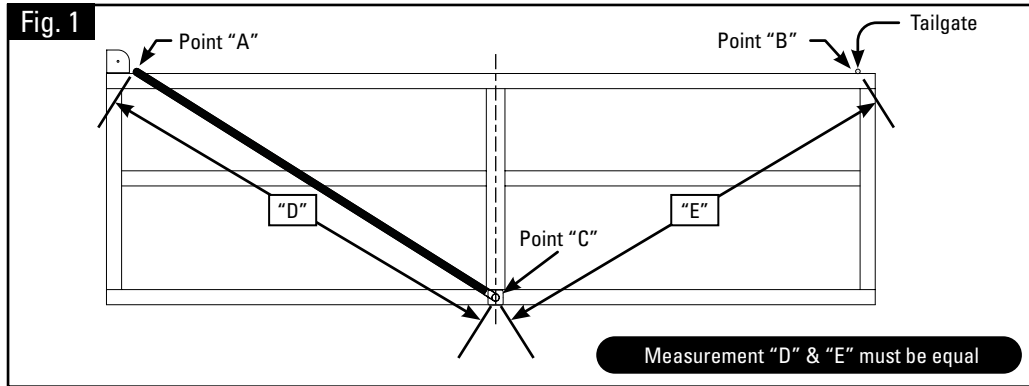

**Step 3a. Arm Preload (for boxes over 22' in length):** Install Arm and Pivot assemblies on Arm Adaptor Plate with Arm indexed (Fig. 3A). Arms must be indexed with no spring load on pivots. Index Arms at 180 degrees of travel from the Roller Mechanism for proper preload of the springs. The dotted lines represent proper 180 degree preload position for applications with Bent Arms. Mark pivot pin location on box.

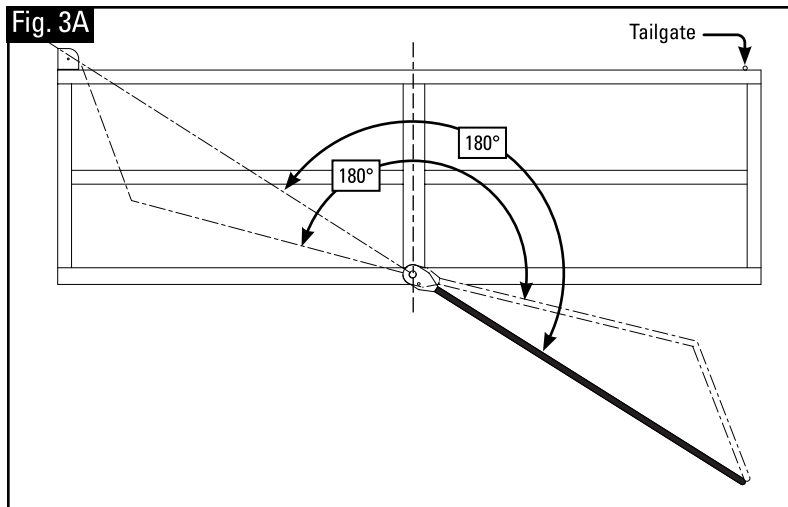

Index Arms at 180 degrees of travel from the Roller Mechanism for proper preload of the springs. The dotted lines represent proper 180 degree preload position for applications with Bent Arms. Mark pivot pin location on box.

**Step 2 - Mounting the Pivot:** For Single Springs pivots weld or bolt the Arm Adaptor Plate in place (Fig. 2).

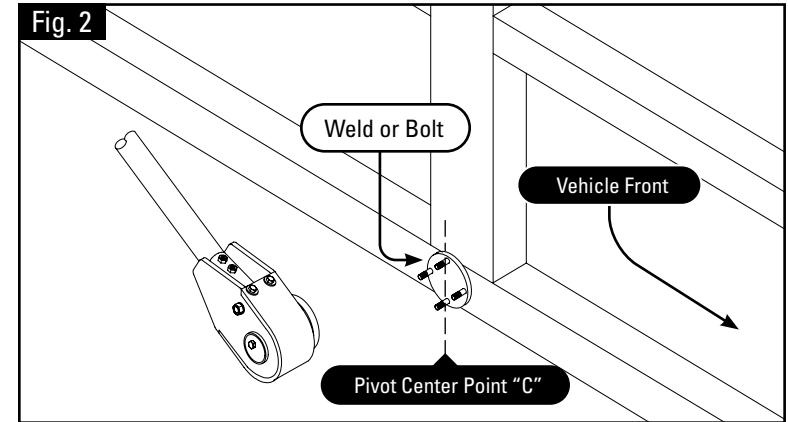

**Step 3b. Arm Preload (for boxes under 22' in length):** Install Arm and Pivot assemblies on Arm Adaptor Plate with Arm indexed (Fig. 3B). Arms must be indexed with no spring load on pivots. Index Arms at 150 degrees of travel from the Roller Mechanism for proper preload of the springs. The dotted lines represent proper 150 degree preload position for applications with Bent Arms. Mark pivot pin location on box.

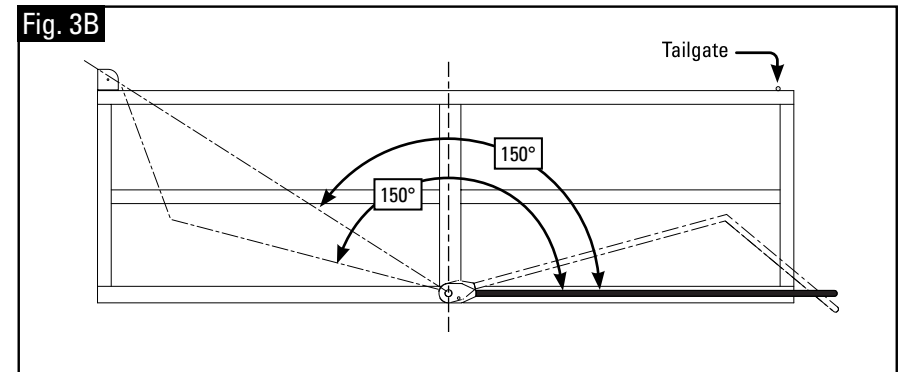



**INSTALLATION INSTRUCTIONS**

**Single Spring Arm Kits**

**Arm Alignment, Tarp and Pullbar Installation**

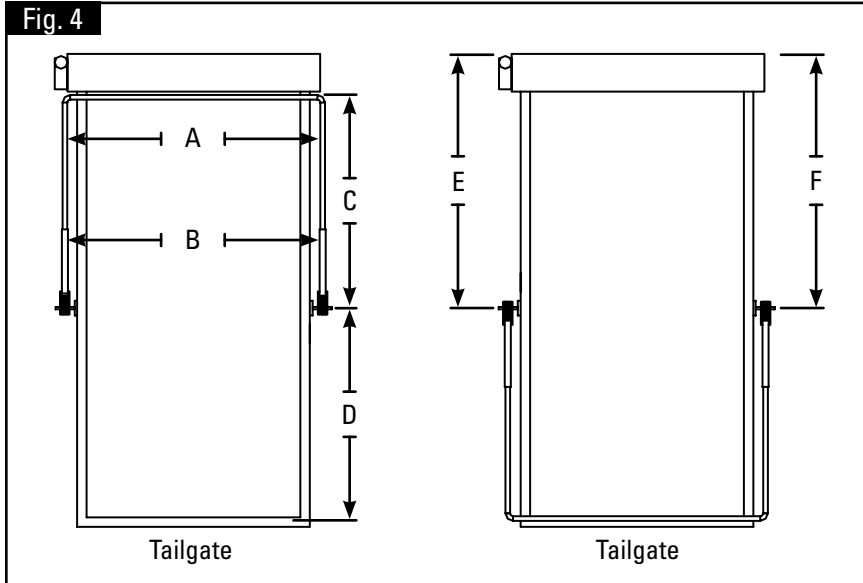

**Step 4 - Correct Alignment of arm to truck:**

Arms and pivots must be square and parallel to truck (Fig. 4).

(Dimension "A" must equal "B" - Dimension "C" must equal "D" - Dimension "E" must equal "F")

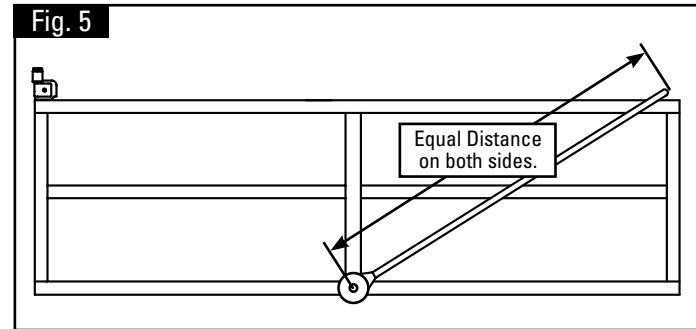

**Step 5:** Adjust the Arms on both sides to be the same length (Fig. 5).

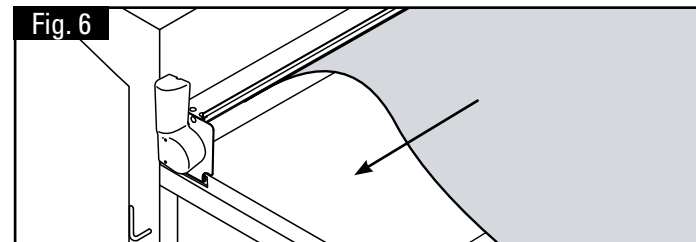

**Step 6 - Tarp Installation:** Slide Tarp into Groove on roller tube and center (Fig. 6).

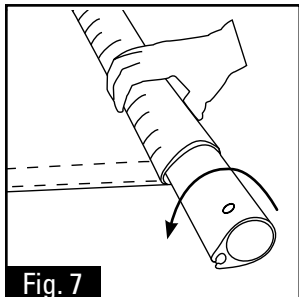

**Step 7 - Installing The Pullbar:** Cut the pullbar to length making sure the arms remain parallel and square to the body.

Slide the tarp into groove in the pullbar and center the tarp.

Roll the tarp up on the pullbar two revolutions (Fig. 7).

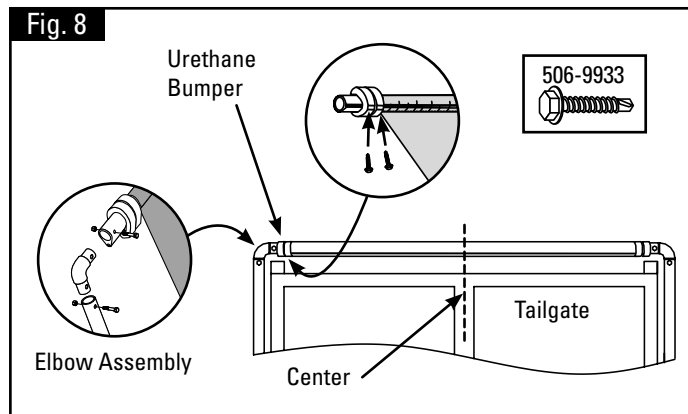

**Step 8:** Fasten the tarp in place by sliding the two urethane bumpers on to the pullbar far enough to touch the edges of the tarp. Lock in place by installing a 1-1/2" long (506-9933) self drilling screw through the bumper and into the hem tube groove of the pullbar (Fig. 8).

For elbows, use the long bolts provided in the kit, when deployed to catch the rope on flap tarps.

**Note: Tarp must be retracted when dumping.**



**INSTALLATION INSTRUCTIONS**

**Single Spring Arm Kits**

**Quick Disconnect Plug Assembly**

**Step 9:** Assemble the Quick Disconnect (Fig. 9, 10 & 11).

Option #1, Plug Assembly - Part # 514-0505.

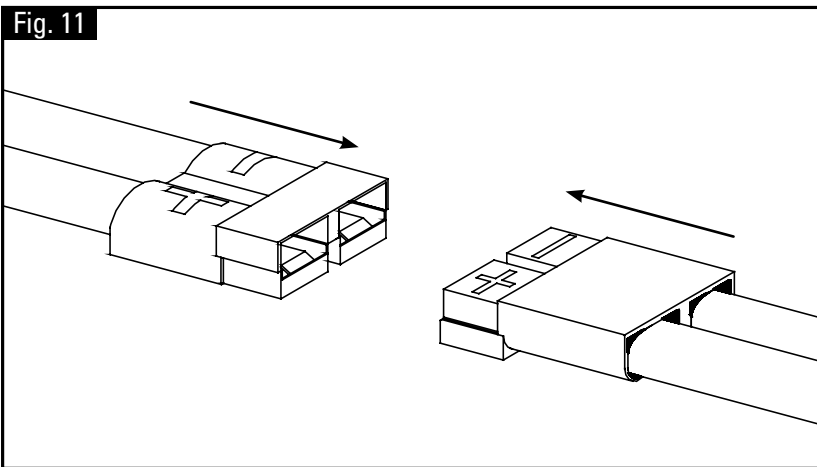
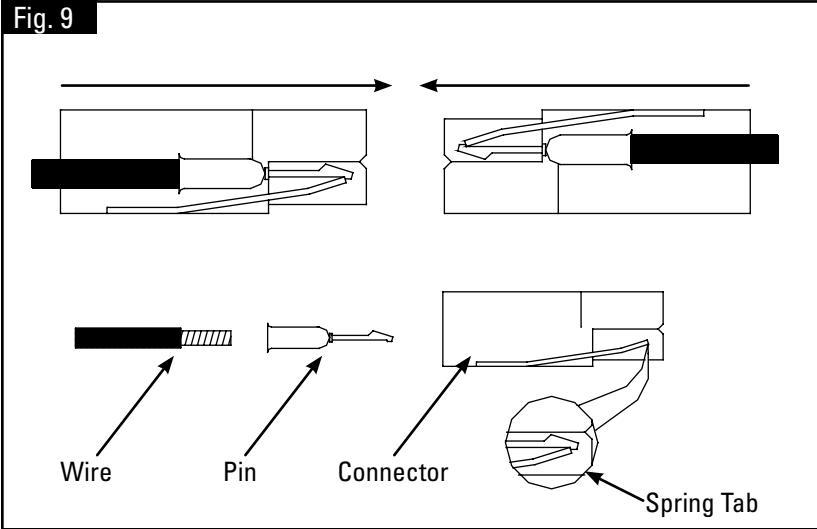

Option #2, Plug Assembly - Part # 514-0501.

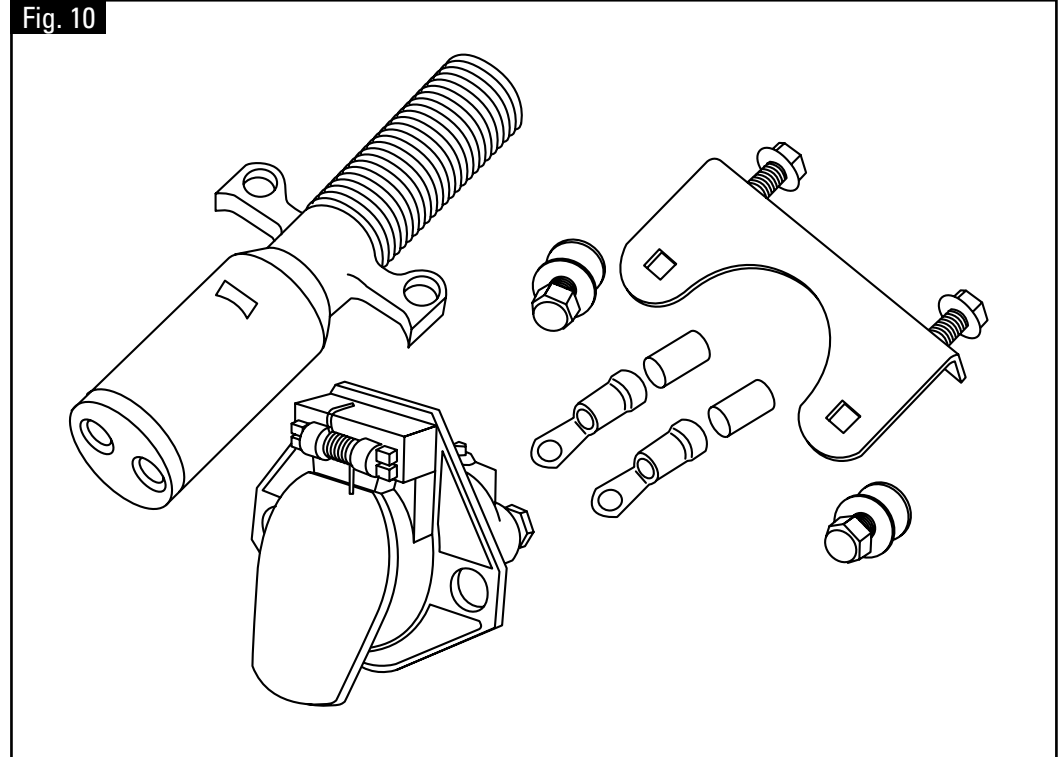



**INSTALLATION INSTRUCTIONS**

**Single Spring Arm Kits**

**Optional Flap Tarp, Rope and Hook Installation**

**Parts:**

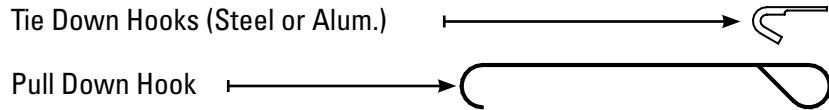

Note: The Location Of The Tie Down Hooks Is Critical!

**Step 1:** Flip the braided rope over the corner so that the flaps and tie down ropes hang over each side of the box. The number of tie down hooks vary depending on the length of your tarp. One pull down hook is included with your Pulltarp system. If needed. Use the hook to pull the braided rope and flaps over the side of the box.

**The tie down hooks must be positioned so that:**

1. The tie down rope can be reached from the ground.
2. The bungee cord has to be stretched to reach the last hook (see Step 2 in **Bungee Cord Installation** section).
3. The rope has no slack.
4. The tie down hooks are level with one another.

**To ensure proper hook placement, first duct tape the rope to the box in place of the tie down hooks. Start with hook closest to the cab.**

1. Position the first hook 6" (15.24cm) down and 12" (30.48cm) forward (toward the cab) from the first grommet (Fig. 12).
2. Position 2nd hook straight down from 1st grommet. This hook should be reached from ground (Fig. 13).
3. Place middle hooks equal distances from grommet (Fig. 14). These hooks should be placed at the same height as the second hook.
4. Position last hook (closest to the tailgate) below the last grommet at the same height as the others (Fig. 15).
5. Weld hooks in place.

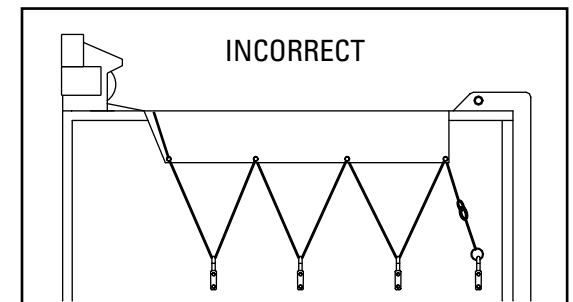
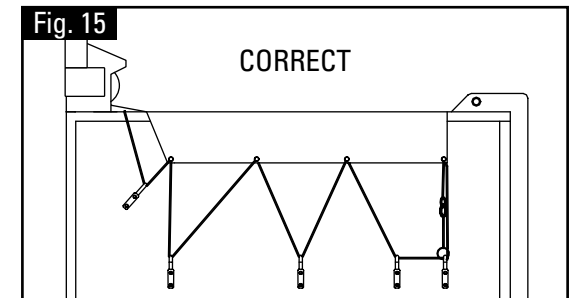
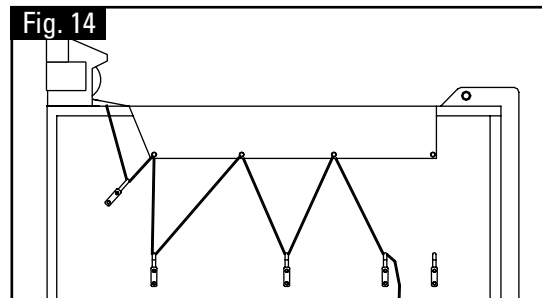
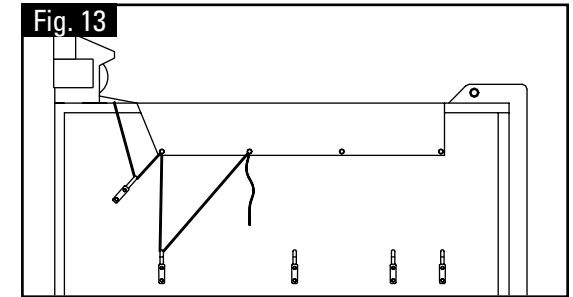
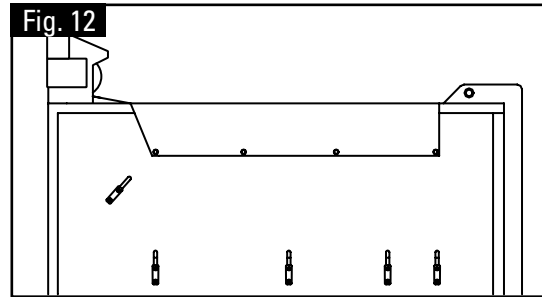





**INSTALLATION INSTRUCTIONS**

**Single Spring Arm Kits**

**Bungee Cord Installation**

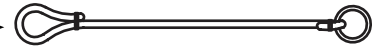
**Parts:**

- 2 Bungee Cords 
- 2 Oval Compression Sleeves 
- 1 Snap Clip 

**Step 2:** After side hooks are installed, the tie down rope must be installed and cut to proper length. It is important to get all of the slack out of the rope to prevent blowing and rubbing of flaps in windy conditions.

**Tarps with Side Flaps**

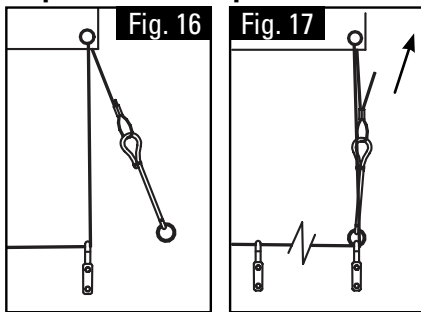

To tighten, pull loose end of rope through the Oval Compression Sleeve (Fig. 16). Stretch the bungee cord making sure all slack is taken out of the rope, crimp compression sleeve (Fig. 17). Be sure to keep flaps even on sides so Tie Down Ropes remain equal in length.

**Note:** Check for proper placement of rope through the last two hooks.

**Snap Clip Installation**

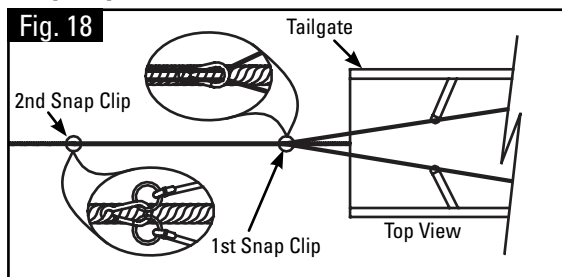

**Note:** First snap clip should not be used on long wheel base belly dumps.

Flip the rope back on top of the tarp, making sure to hold the bungee at all times. The first snap clip is factory installed 5'-6" from the pullrod. Open the clip and enclose the rope. Weave the second clip through the main pullrope where the ends of the bungee cords meet the main pullrope. Make sure the rope is taught when clipped (Fig. 18).

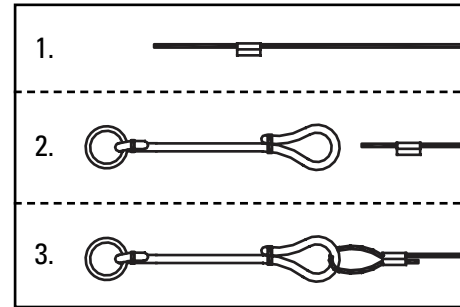

**Connect Bungee Cord to Rope**

1. Thread braided rope through Oval Compression Sleeve.
2. Feed rope through the eye of the bungee cord.
3. Thread the rope back through the oval compression sleeve. Adjust for proper length. Crimp compression sleeve.

**Excess Rope**

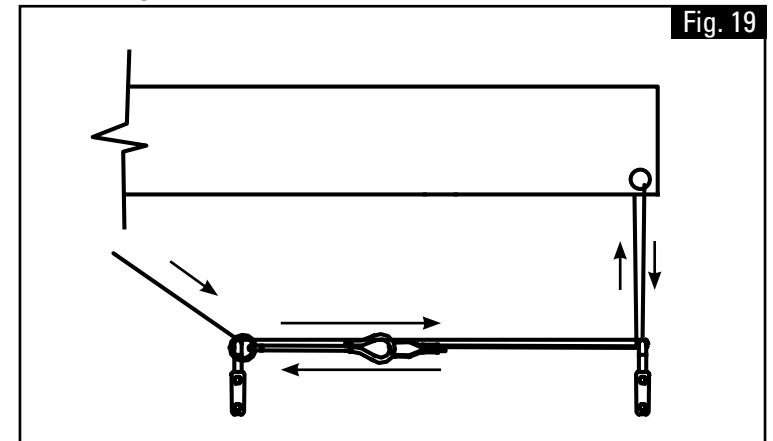

You may need extra rope to keep the side flap system ground operated. If your application requires extra rope, the slack needs to be taken up by attaching the end of the bungee cord to an alternate hook (Fig. 19).



**INSTALLATION INSTRUCTIONS**

**Single Spring Arm Kits**

**Flap, Rope and Rope Hook Placement**

**Step 3 - Flap / Tie Down Rope Placement and Installation (Fig. 20).**

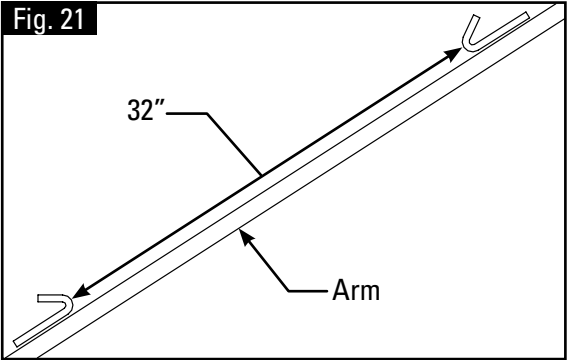
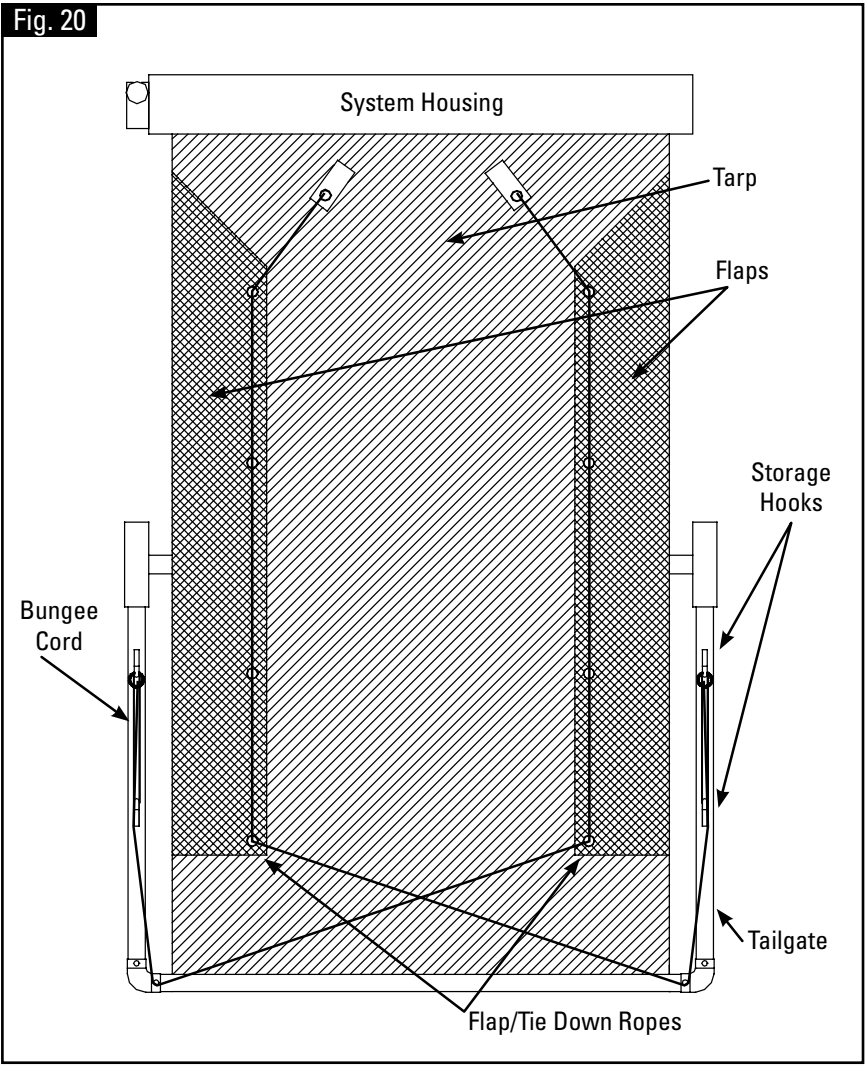

**Step 4 - Rope Hook Placement:** Weld rope storage hook on the top of the arms approx. 32" apart (Fig. 21).

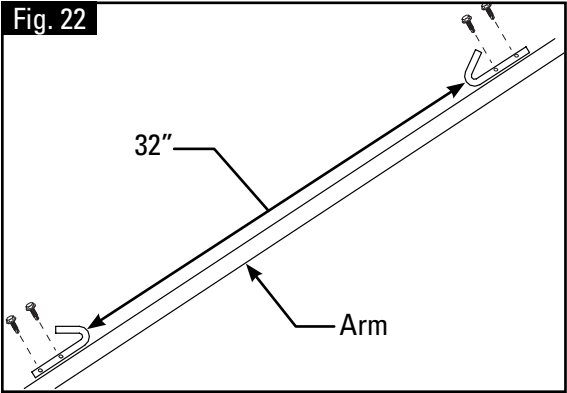

**Step 5 - Rope Hook Placement For Aluminum Arms:** Use Self Drilling screws (part #506-9933) to install hooks (Fig. 22).

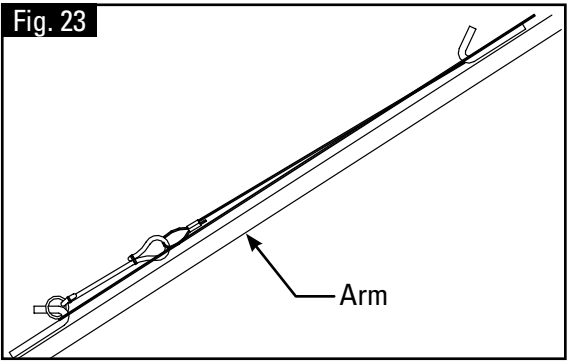

**Step 6 - Rope storage on Arms:** (Fig. 23).